

NORDO'S  
*Culinarium*<sup>™</sup>  
109 SOUTH MAIN STREET SEATTLE, WA 98104

Thank you for considering Nordo's Culinarium for your private event. Below you will find all the information you need for renting our versatile space in heart of historic Pioneer Square.

### Venue Features

*Below you will find what is included in your basic rental.*

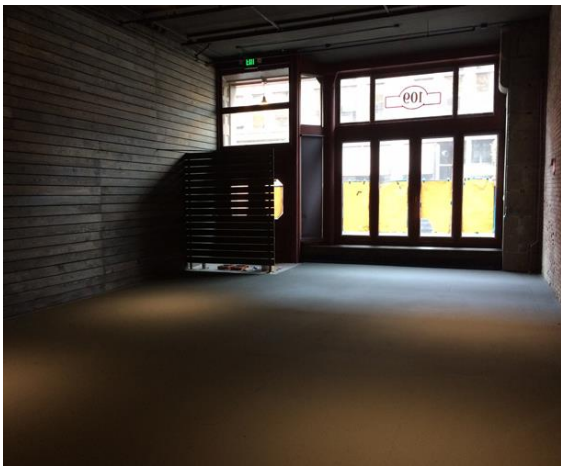

- 2,000 sq ft of event space able to accommodate 100 people standing, or 60 seated
- 8 hour rental period with option to purchase additional hours
- 2 Custom built portable copper bars able to make different configurations.
- Changing rooms and storage
- Full length black velour curtains able to be hung at different locations in the venue
- Basic lighting scheme
- Basic speaker setup with an iPod connection
- Portable coat closet
- Wireless Internet
- Easy loading and unloading area in the alley
- Facility Manager to work with you the entire evening
- Basic venue clean-up after your event

Based on information provided by the renter, Nordo's Culinarium will issue a proposal and contract. Rates are vary based on season and day of week. Please contact us so we can discuss your specific event.

A deposit is required to hold a date, with full payment due day of event. In addition, a damage deposit of \$500 is required no later than 7 days prior to the event. The deposit is fully refundable against any additional costs and is a separate payment in addition to the rental fee. In the event that you must cancel your rental, the damage deposit is refundable. The renter must provide a certificate of liability insurance.

Your rental will include a 1-hour consultation to discuss all details. We recommend scheduling the meeting 7 to 10 days prior to your event.

A Facility Manager will be on-site during venue rentals to assist you with operations and walk through the venue at the close of the event. Ticketing and Front of House staffing can be added for an additional fee. If you are interested in light and sound we can provide you with a technician for an additional fee.

Discounted rates are available for 501(c)(3) nonprofit organizations.

## **Additional Features Available for Rental**

*For a complete inventory and rates please contact us.*

- Standard dining tables of various sizes, bistro tables, and chairs
- 4 portable stages 4'x6' that can be locked in a variety of shapes
- Mounted projector with easy hookup
- New theatrical sound system able to accommodate single speakers, DJs, or a small band
- State of the art theatrical lighting system covering the entire floor plan with moveable and dimmable lighting fixtures
- Technical personnel to help with all your lighting and sound needs
- Fully equipped 1000 sq. foot commercial kitchen
- Staffed bar including the option of cocktail waitresses. Please ask about our bar minimums and products. We are willing to meet a variety of budgets and requests. A bartender and sommelier are available to discuss your event.
- Glassware, plateware, flatware, and serving ware
- A variety of entertainment packages from a full dinner show to an evening of music, a DJ, or an hour-long cabaret.

## **Venue Contact**

Please connect with us to express how the Culinarium can be tailored to your venue needs. To discuss dates, rental rates or to schedule a time to view the space, please contact us at [info@cafenordo.com](mailto:info@cafenordo.com).

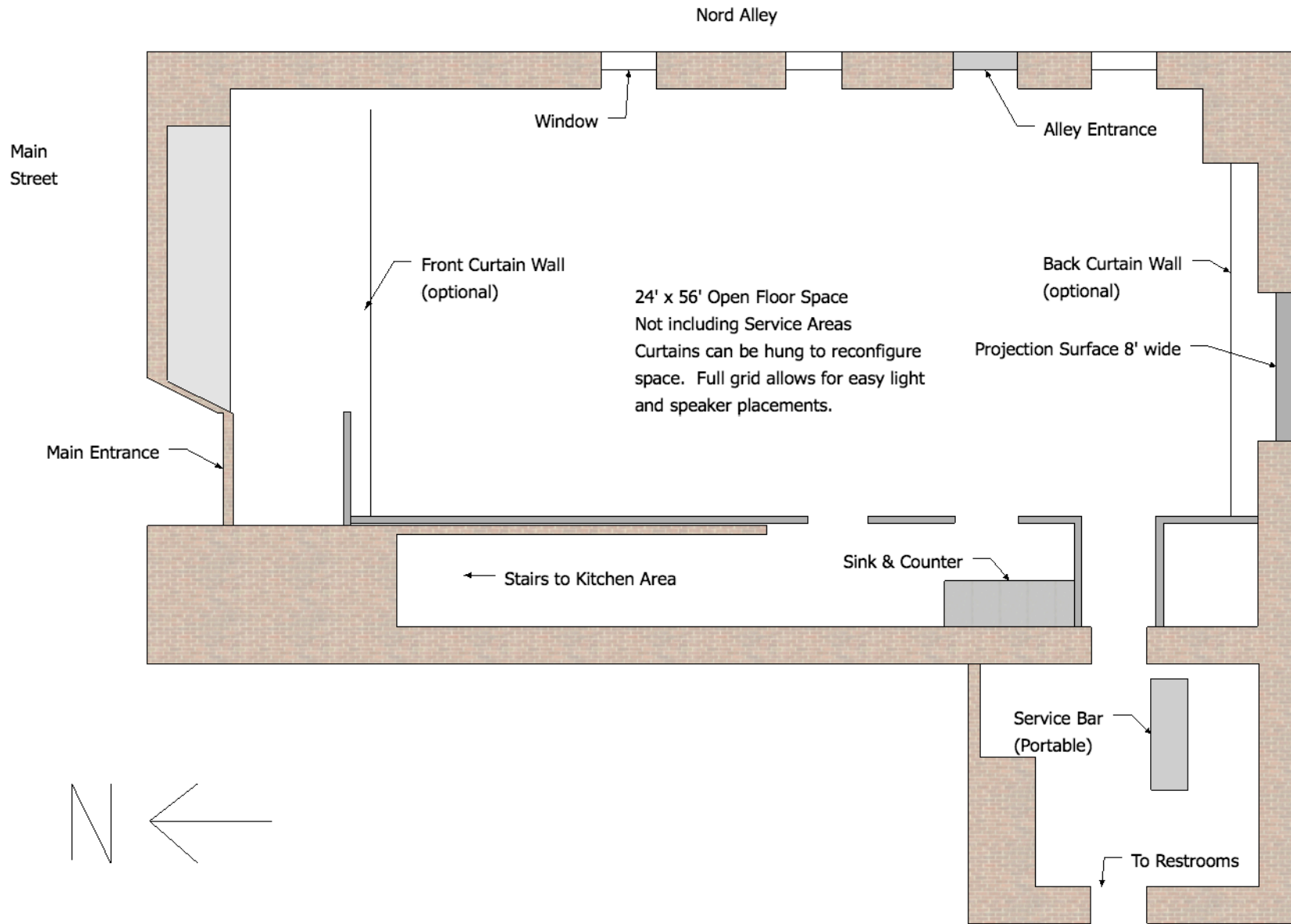



109 SOUTH MAIN STREET SEATTLE, WA 98104

## Rental Inventory

### Furniture:

- 70 Black Folding Chairs
- 10 4' Round 6 Top Tables
- 3 Square Wood 4 Top Tables
- 4 Square Wood 2 Top Tables
- 4 Round Wood 3-4 Top Tables
- 5 High Bistro 2 Top Tables with Chairs
- 40 Candelabras
- Portable Stage (4 4'x6' Platforms that can be locked together in various configurations. Max Size 8'x12'. Adjustable heights.)

### Kitchen:

- More details available upon request
- White/ Red/ Water Glassware
- Standard bar Glassware
- Silverware
- White Salad Ovals
- White Soup Bowls
- White 10" Round Dinner Plates
- White Small Squares
- White Serving Bowls & Platters with Utensils
- Assorted Silver Serving Platters

### Tech Equipment:

### Sound Equipment:

- Mackie Onyx 1640 16-channel mixer with Firewire option
- Lexicon MPX100 digital effects unit
- 2 monitor mixes with 31-band EQ
- 2JBL monitor wedges
- 2 QSC K10 FOH speakers
- 6 Electro Voice EVU-1062 6" surround speakers
- 2 DIs
- Mac Mini with QLab
- Crown CTS4200 4-channel power amp
- 8 channels of Shure ULX wireless (G3 band)
- 8 Shure transmitter belt packs
- 8 Countryman B3 lavalier mics
- 2 Shure Beta 58 wireless handheld mic
- Other Mics & Stands available

### Lighting Equipment

- ETC Ion Board
- (10) Source 4 50 deg
- (14) Source 4 36 deg
- (7) Source 4 26 deg
- (12) Source 4 Par
- Focusrite Saffire Pro 40 A/D/A
- String Lights
- (4) 10" Fresnel
- (8) Altman 6x9
- (12) Par 20
- (12) 4 Channel DMX Dimmers
- (2) I Cue Mirrors (40 ft.)